

NOTES:

- 1) FOR ACADEMIC USE ONLY. CONSTRUCTION AND/OR POSSESSION MAY BE IN VIOLATION OF LOCAL, STATE AND FEDERAL STATUTES.
- 2) INTENDED FOR USE WITH .22 SHORT OR .22 LR SUBSONIC AMMUNITION ONLY. DO NOT USE .22 LR HIGH VELOCITY AMMUNITION.

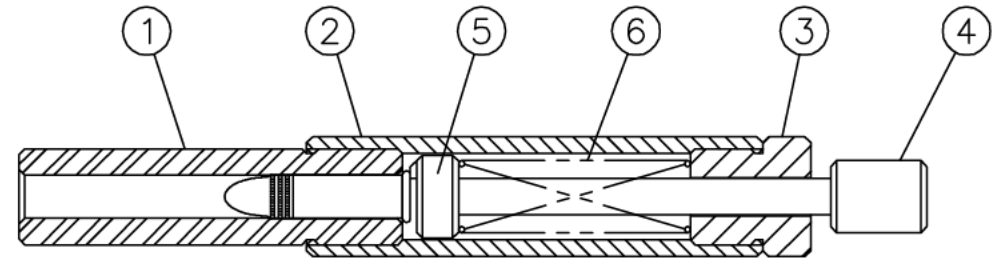

- 3) THE SPRING (DETAIL No. 6) PROVIDES THE FORCE NEEDED TO FIRE THE ROUND, BUT ALSO ABSORBS THE RECOIL FROM THE SPENT CASING AS THE BULLET EXITS THE BARREL. SELECTION OF THE CORRECT SPRING MAY REQUIRE SOME TESTING -- IF THE SPRING IS TOO WEAK, IT WILL BE COMPRESSED SOLID AND PERMANENTLY DAMAGED.
- 4) WHEN A ROUND IS PLACED IN THE CHAMBER AND IS READY FOR FIRING, THE STRIKER IS RESTING ON THE CARTRIDGE RIM. DROPPING THE DEVICE OR HITTING THE STRIKER MAY CAUSE THE ROUND TO FIRE PREMATURELY. AS WITH ANY FIREARM, EXERCISE EXTREME CAUTION.

5) AND REMEMBER...
WIPE YOUR FEET,
DON'T SLAM THE
DOOR, EAT YOUR
VEGETABLES AND
SAY YOUR
PRAYERS.

6	1	1	SPRING - ϕ 0.38 OD X 1.5 LG	PURCHASED
5	1	5	STRIKER ASSEMBLY	SEE SHEET 5
4	1	4	COCKING KNOB	SEE SHEET 4
3	1	4	END CAP	SEE SHEET 4
2	1	3	BODY	SEE SHEET 3
1	1	2	BARREL	SEE SHEET 2
ITEM	QTY	SHEET	DESCRIPTION	MATERIAL

*THE DESIGN OF THIS DEVICE IS NOT
COPYRIGHTED AND IS PUBLIC DOMAIN.
IT MAY NOT TO BE SOLD FOR PROFIT.*

*EL DISEÑO DE ESTE DISPOSITIVO NO ES
COPYRIGHTED Y ES PUBLIC DOMAIN. NO
PUEDE SER VENDIDO PARA EL BENEFICIO.*

TOLERANCES UNLESS OTHERWISE SPECIFIED			TITLE	
.XX \pm 0.010	.XXX \pm 0.005	ANGLES \pm 1°	PEN GUN - Mk1	
SCALE	DRAWN BY	DATE		
FULL	E. MARTILLO	29 SEPT 03	DWG NO.	REV
APPROVED			030929	—

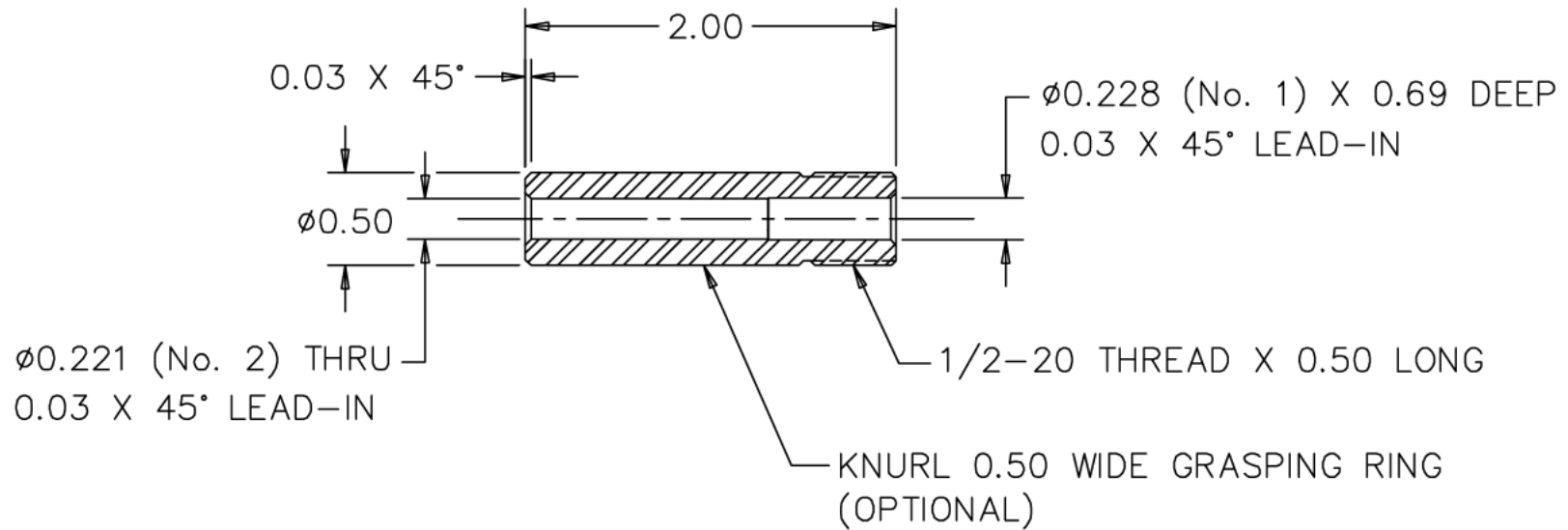

① BARREL

MATERIAL: STEEL OR BRASS
 QUANTITY: 1

OPTIONAL MATERIAL: HEX HEAD CAP SCREW
 1/2-20 X 1 1/2 LONG

THE DESIGN OF THIS DEVICE IS NOT
 COPYRIGHTED AND IS PUBLIC DOMAIN.
 IT MAY NOT TO BE SOLD FOR PROFIT.

EL DISEÑO DE ESTE DISPOSITIVO NO ES
 COPYRIGHTED Y ES PUBLIC DOMAIN. NO
 PUEDE SER VENDIDO PARA EL BENEFICIO.

TOLERANCES UNLESS OTHERWISE SPECIFIED

.XX ± 0.010 .XXX ± 0.005 ANGLES ± 2°

SCALE DRAWN BY DATE

FULL E. MARTILLO 29 SEPT 03

APPROVED

TITLE

PEN GUN — Mk1

DWG NO.

030929

REV

—

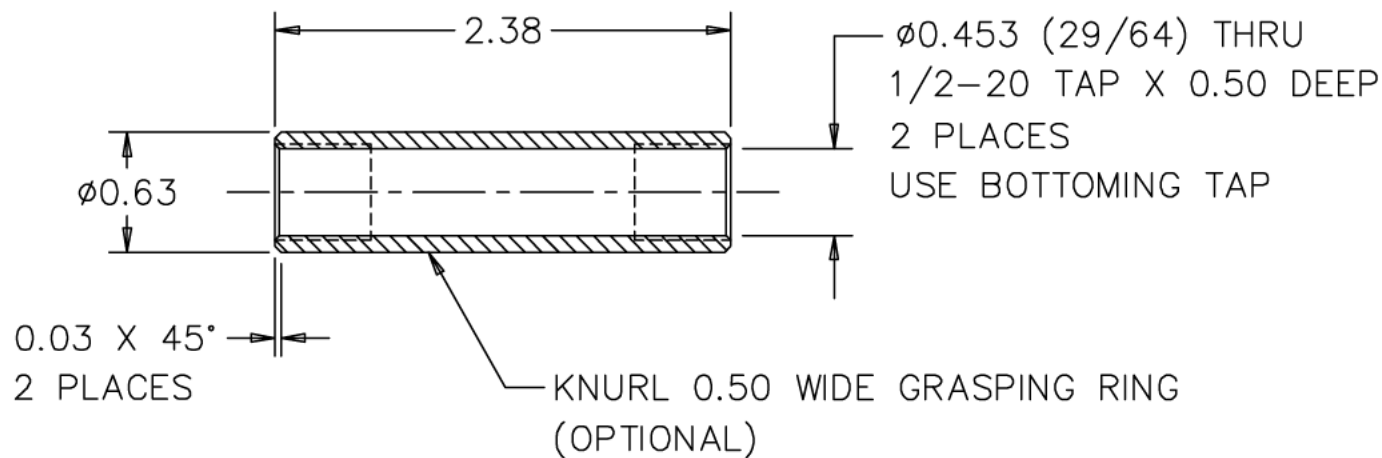

② BODY

MATERIAL: STEEL, BRASS OR ALUMINUM

QUANTITY: 1

OPTIONAL MATERIAL: STEEL TUBING

$\phi 5/8$ OD X 0.083 WALL ($\phi 0.459$ ID)

<p>THE DESIGN OF THIS DEVICE IS NOT COPYRIGHTED AND IS PUBLIC DOMAIN. IT MAY NOT TO BE SOLD FOR PROFIT.</p> <p>EL DISEÑO DE ESTE DISPOSITIVO NO ES COPYRIGHTED Y ES PUBLIC DOMAIN. NO PUEDE SER VENDIDO PARA EL BENEFICIO.</p>	TOLERANCES UNLESS OTHERWISE SPECIFIED			TITLE	
	.XX ± 0.010	.XXX ± 0.005	ANGLES ± 2°		PEN GUN – Mk1
	SCALE	DRAWN BY	DATE	DWG NO. 030929	
	FULL	E. MARTILLO	29 SEPT 03		REV —
	APPROVED				

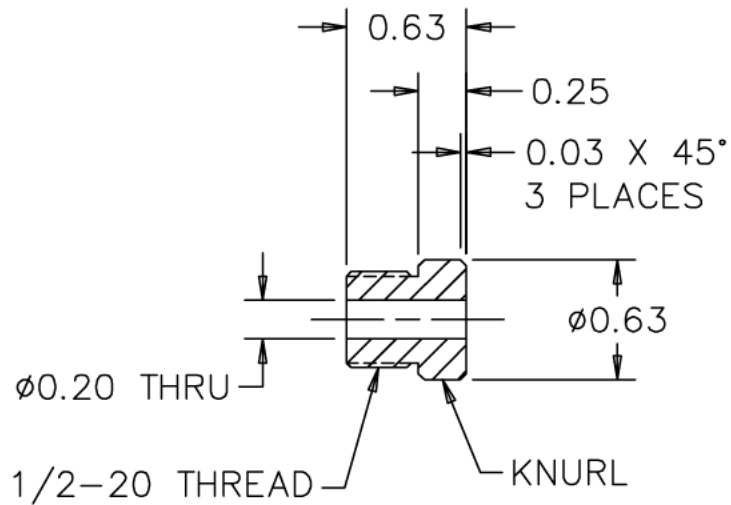

③ END CAP

MATERIAL: STEEL, BRASS, ALUMINUM OR PLASTIC

QUANTITY: 1

OPTIONAL MATERIAL: HEX HEAD CAP SCREW
1/2-20 X 3/4 LONG

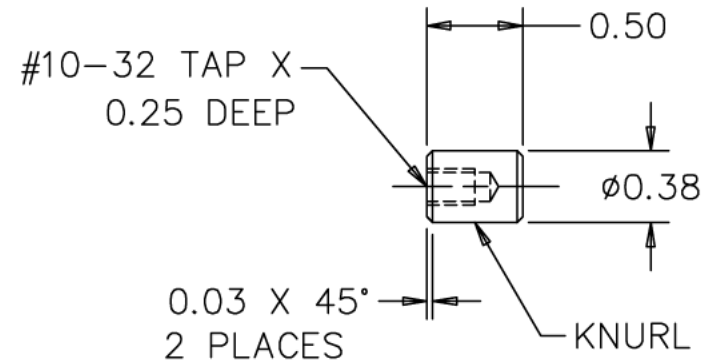

④ KNOB

MATERIAL: STEEL, BRASS, ALUMINUM OR PLASTIC

QUANTITY: 1

THE DESIGN OF THIS DEVICE IS NOT
COPYRIGHTED AND IS PUBLIC DOMAIN.
IT MAY NOT TO BE SOLD FOR PROFIT.

EL DISEÑO DE ESTE DISPOSITIVO NO ES
COPYRIGHTED Y ES PUBLIC DOMAIN. NO
PUEDE SER VENDIDO PARA EL BENEFICIO.

TOLERANCES UNLESS OTHERWISE SPECIFIED

.XX ± 0.010 .XXX ± 0.005 ANGLES ± 2°

SCALE DRAWN BY DATE

FULL E. MARTILLO 29 SEPT 03

APPROVED

TITLE

PEN GUN - Mk1

DWG NO.

030929

REV

—

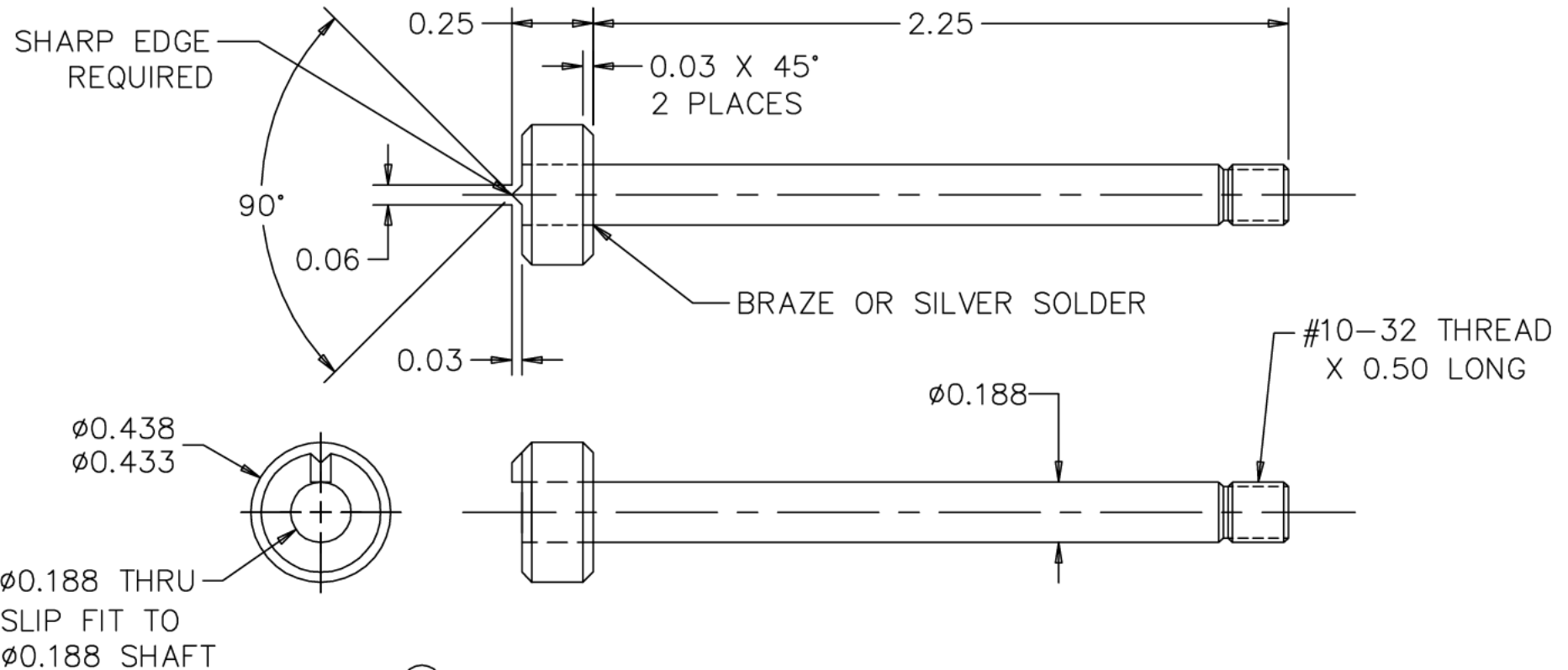

⑤ STRIKER ASSEMBLY

MATERIAL: STEEL OR BRASS
 BRAZE OR SILVER SOLDER WHERE INDICATED
 QUANTITY: 1

OPTIONAL CONSTRUCTION: MACHINE FROM BAR STOCK

<p>THE DESIGN OF THIS DEVICE IS NOT COPYRIGHTED AND IS PUBLIC DOMAIN. IT MAY NOT TO BE SOLD FOR PROFIT.</p> <p>EL DISEÑO DE ESTE DISPOSITIVO NO ES COPYRIGHTED Y ES PUBLIC DOMAIN. NO PUEDE SER VENDIDO PARA EL BENEFICIO.</p>	TOLERANCES UNLESS OTHERWISE SPECIFIED			TITLE
	.XX ± 0.010	.XXX ± 0.005	ANGLES ± 2°	
	SCALE	DRAWN BY	DATE	DWG NO. 030929
	2X	E. MARTILLO	29 SEPT 03	
APPROVED				